

TREES	SIZE	NOTES	New Woodland approx %	Advance	Restoration	New Scrub approx %	Restoration	New Hedge approx %	Advance-east of site	Restoration - NE site	Total
<b>TOTAL TREES</b>											
<i>Acer campestre</i> (Field Maple)	0.45-0.6m Trans.	Woodland to be planted as a	28,000	10,220	20,280	18,310	18,310	10	1,080	330	1,178
<i>Betula pendula</i> (Silver Birch)	0.35-0.4m c/g.	be planted at 2.5m c/s	5	82	162	5	229	10	540	165	718
<i>Betula pubescens</i> (Downy Birch)	0.35-0.4m c/g.	Scrub at 2.0m c/s	5	82	162	5	229	10	540	165	718
<i>Malus sylvestris</i> (Crab Apple)	0.35-0.45m Trans.	and protected with	5	82	162	5	229	10	540	165	718
<i>Prunus avium</i> (Wild Cherry)	0.45-0.6m Trans.	Tube tree shelters	5	82	162	5	229	10	540	165	718
<i>Quercus robur</i> (Pendunculate Oak)	0.35-0.45m Trans.	cp denotes call	25	410	812	25	410	5	270	82	1,574
<i>Sorbus aucuparia</i> (Rowan)	0.45-0.6m Trans.	grown stock.	7	114	227	5	229	10	540	165	570
<b>TOTAL TREES</b>			62	1,016	2,012	20	916	22	1,188	362	5,494
<b>SHRUBS</b>											
<i>Corylus avellana</i> (Hazel)	0.45-0.6m Trans.	*denotes species to be planted as a	5	82	162	10	458	5	270	83	1,055
<i>Crataegus monogyna</i> (Hawthorn)	0.45-0.6m Trans.	shrub edge field side	10	164	325	30	1,374	40	2,160	660	4,683
<i>Euonymus europaeus</i> (Spindle)	0.45-0.6m Trans.	Hedgerow interplanting	2	34	65	5	229	5	270	83	328
<i>Fraxinus alnus</i> (Alder Buckthorn)	0.35-0.45m Trans.	at 5 plants per linear	3	49	97	5	229	3	162	50	587
<i>Ilex aquifolium</i> (Holly)	0.45-0.6m Trans.	metre, double	3	49	97	10	458	8	432	132	1,168
<i>Prunus spinosa</i> (Blackthorn)	0.45-0.6m Trans.	staggered row	5	82	162	10	458	5	270	83	1,055
<i>Rosa canina</i> (Dog Rose)	0.35-0.45m Trans.		5	82	162	10	458	5	270	83	1,055
<i>Sambucus nigra</i> (Elder)	0.45-0.6m Trans.		10	164	325	10	458	5	270	83	352
<i>Salix caprea</i> (Goat Willow)	0.45-0.6m Trans.		5	82	162	5	229	2	108	33	1,088
<i>Viburnum opulus</i> (Guelder Rose)	0.35-0.45m Trans.		5	82	162	5	229	5	270	83	352
<b>TOTAL SHRUBS</b>			38	624	1,233	80	3,664	78	4,212	1,288	11,021
<b>TOTAL TREES &amp; SHRUBS</b>			100	1,640	3,245	100	4,580	100	5,400	1,650	16,515

**Maintenance**  
All planting to be maintained by use of glyphosate to create a 1.0m diameter circle around each tree and shrub during the five year aftercare period, or until canopies close. This will permit rapid establishment. Two maintenance visits will be carried out per year during the aftercare period, one in spring and one in early summer. Visits will include weed control (including noxious weeds), litter removal and checking and firming up tree shelters. Any plants dying during the five-year aftercare period will be replaced with a size and species to be agreed with the Mineral Planning Authority to maintain 100% stocking rate during the aftercare period and to achieve a minimum 95% stocking rate (to allow for expected plant growth). Any plants loosened by frost or wind will be firmed up and any damaged branches will be removed using a sharp pruning knife. At the end of the aftercare period, or before, should growth warrant it, tree shelters will be removed from the planting.

**Programme of Implementation**  
To be carried out in November-March planting season for bare root stock. Prior to planting, any areas of compaction to be broken up to a depth of 450mm. Trees and shrubs to be notch planted.

Revisions	
Based on the Ordnance Survey Digital Map Data with the permission of Her Majesty's Stationary Office, 10 Crown Copyright. Licence No. 100018131	
Planning Department CEMEX UK Operations Limited CEMEX House, Evreux Way Rugby, Warwickshire CV21 2DT Telephone 01788 517000	
Drawn By	A W
Date	8 Nov 2022
Scale(s) @A1	1 : 2500
Chkd	
Site Ref.	
Company	CEMEX UK Operations Limited
Site	HAMBLE AIRFIELD
Project	SAND AND GRAVEL EXTRACTION
Title	CONCEPT RESTORATION PLAN
Drawing No.	21-08-HAMB-1717-P1-REST Rev A

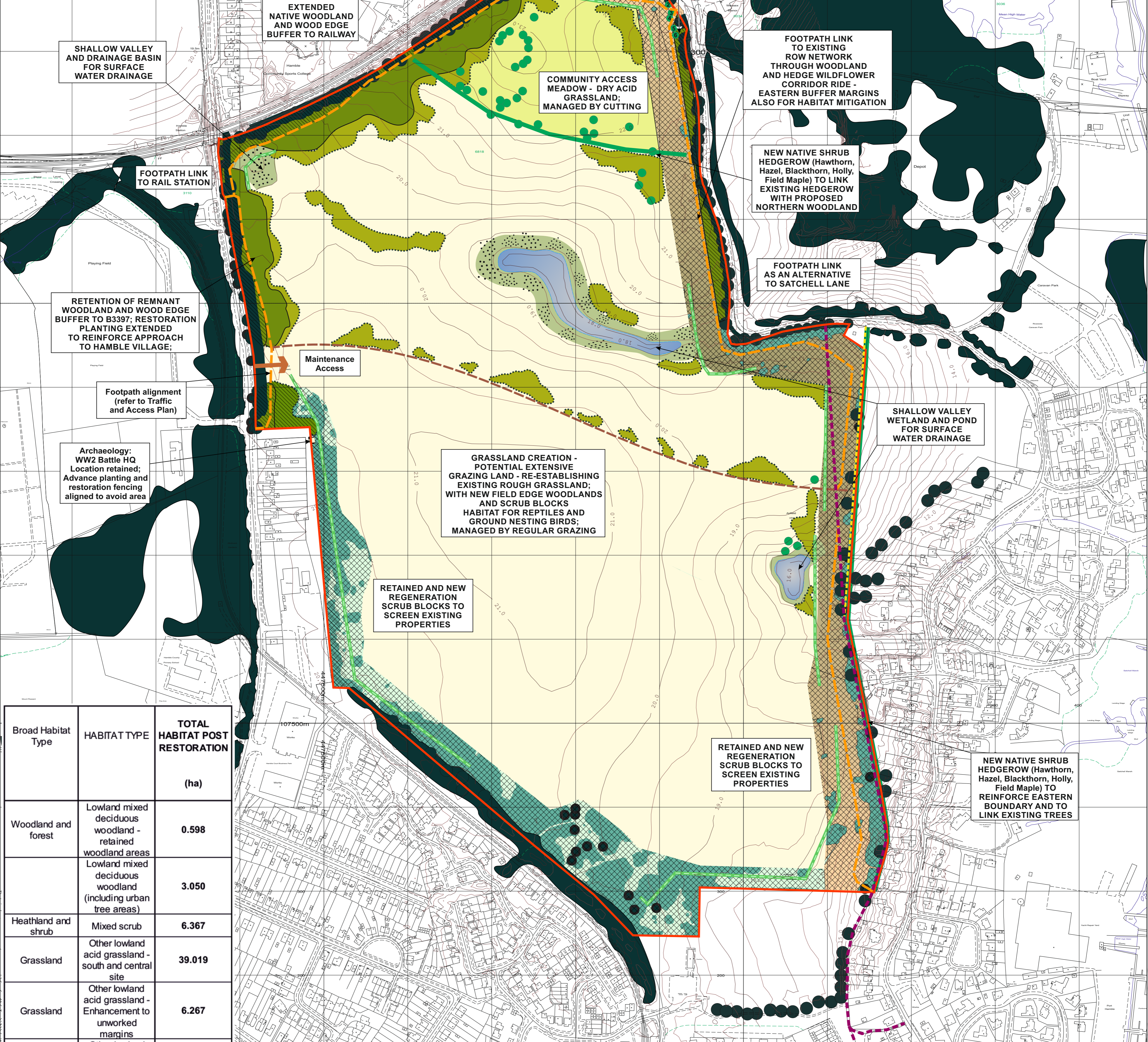

Broad Habitat Type	HABITAT TYPE	TOTAL HABITAT POST RESTORATION (ha)
Woodland and forest	Lowland mixed deciduous woodland - retained woodland areas	0.598
	Lowland mixed deciduous woodland (including urban tree areas)	3.050
Heathland and shrub	Mixed scrub	6.367
Grassland	Other lowland acid grassland - south and central site	39.019
Grassland	Other lowland acid grassland - Enhancement to unworked margins	6.267
Grassland	Other lowland acid grassland - north of site	2.870
Lakes	Temporary lakes, ponds and pools	0.547
Wetland	Fens (upland and lowland)	1.176
Urban	Existing Gravel/Grass Footpath	0.146
<b>AREA TOTAL:</b>		<b>60.040</b>
Number:		66
<b>HABITAT POST RESTORATION (linear km)</b>		
Hedgerow	New Native Species Rich Hedgerow	1.019
Hedgerow	Enhancement of Native Species Rich Hedgerow with trees	0.180
Hedgerow	Enhancement of Native Species Rich Hedgerow with trees	0.550

KEY :	
	APPLICATION BOUNDARY
	EXISTING VEGETATION - Trees, Scrub and Grassland
	PROPOSED CONTOURS m.A.O.D (1.0m INTERVALS)
	EXISTING Public Right of Way
	Undesignated Footpath Link
	PROPOSED PERMISSIVE PATH - grassed surface
	DENOTES PLANTING WHICH CAN BE CARRIED OUT AS WORKS AT START OF OPERATIONAL PHASE
	NEW NATIVE HEDGEROW (Hawthorn, Hazel, Blackthorn, Holly) Includes a proportion of Feathered trees to provide shade for grazing animals
	WOOD EDGE / DRY HEATH SHRUB SCRUB - Hawthorn, Blackthorn, Holly, Gorse, Broom; to deter access, to direct path users. Planted as small 10-100m² clumps within designated areas to give an overall 50% cover
	WOOD AND WOOD EDGE - Oak, Rowan, Birch, Hawthorn; Planted as medium 100-1000m² clumps within designated areas to give an overall 75% cover
	PROPOSED DRAINAGE INFILTRATION ZONE (Trench backfilled with permeable material)
	DENOTES UNWORKED BUFFER - SCRUB AND GRASSLAND RETAINED AND MANAGED DURING THE OPERATIONAL PHASE. SOURCE FOR NATURAL RECOLONISATION OF ADJACENT GRASSLAND AREAS
	FOOTPATH CORRIDOR - EXISTING AND NEW HEDGEROW WITH WILDFLOWER GROUND FLORA RETAINED AND EXTENDED BY NATURAL COLONISATION
	LAND RESTORED TO GRASSLAND Paddock BY NATURAL COLONISATION FROM ADJACENT RETAINED GRASSLANDS OR SEEDING WITH AN APPROPRIATE MIX
	SPECIES RICH ACID GRASSLAND - PARKLAND For Community Access; by natural colonisation from adjacent retained grasslands or spreading green hay or seeding with an appropriate mix
	SHALLOW POND (UP TO 1.5-2.0m) For surface water drainage - periodically dry. Marginal vegetation to establish by natural colonisation, seeding and plug planting
	FEN / MIRE ACROSS LOW LYING RESTORED AREAS (SEASONALLY WET, NATURAL COLONISATION eg. Sedges and Rushes); Microtopography - Localised Scrapes and Shallows +/- 0.3-1.0m to create additional habitat
	PROPOSED POST AND RAIL FENCING (For Main Field Areas) - Timber or Metal Estate Fencing; NB all planting and hedgerows to be timber post and stockproof wire fenced on the field side